

14 June 2017 at 7.00 pm

Conference Room, Argyle Road, Sevenoaks  
Despatched: 05.06.17



# Sevenoaks Joint Transportation Board

## Membership:

Chairman, District Cllr. London; Vice-Chairman, County Cllr. Chard

### District Councillors

Barnes, Clack, Edwards-Winsler, Esler, Layland and Williamson

### The County Councillors for the 6 County Electoral Divisions representing the Sevenoaks District

Brazier, Mrs. Crabtree, Gough, Horwood, and Lake

### The representative from the Kent Association of Local Councils (non voting) Parish Cllr. Robson (Reserve Cllr. Dilley)

## Agenda

There are no fire drills planned. If the fire alarm is activated, which is a continuous siren with a flashing red light, please leave the building immediately, following the fire exit signs.

	Pages	Contact
Apologies for Absence		
1. <b>Minutes</b> To agree the Minutes of the meeting of the Board held on 8 March 2017, as a correct record	(Pages 1 - 4)	
2. <b>Declarations of interest</b>		
3. <b>Matters Arising/Update (Including Actions from Previous Meetings)</b>	(Pages 5 - 6)	
4. <b>Referral from Cabinet</b>	(Pages 7 - 8)	
5. <b>Presentation of Petition for Salisbury Avenue</b>		
6. <b>Sevenoaks Residents' Parking Review</b>	(Pages 9 - 12)	John Strachan Tel: 01732 227310

- |     |  |                 |  |
|-----|--|-----------------|--|
| 7.  | <b>Update on Parking on The Rise, Weald Road and Ashgrove Road</b>               |                 | KCC - Emma Gregson<br>Tel: 03000 418181                |
| 8.  | <b>Minor on Street Parking Proposals Various Locations - TRO 2013 Amended 23</b> | (Pages 13 - 28) | Jeremy Clark<br>Tel: 017322 27323                      |
| 9.  | <b>Applications for Disabled Persons' Parking Bays</b>                           | (Pages 29 - 34) | Jeremy Clark<br>Tel: 017322 27323                      |
| 10. | <b>Sevenoaks Highway Works Programme</b>   | (Pages 35 - 48) | KCC - Carol Valentine/ Julian Cook<br>Tel: 0300 418181 |
| 11. | <b>Notes of the Cycling Strategy Working Group - May 2017</b>                    | (Pages 49 - 52) | Councillor John Edwards-Winsor                         |

#### EXEMPT INFORMATION

At the time of preparing this agenda there were no exempt items. During any such items which may arise the meeting is likely NOT to be open to the public.

Please note the following reports may be of interest for information and can be found on the Sevenoaks District Council website:

1. Deferred Parking Restrictions - Station Road, Otford

If you wish to obtain further factual information on any of the agenda items listed above, please contact the named officer prior to the day of the meeting.

Should you need this agenda or any of the reports in a different format, or have any other queries concerning this agenda or the meeting please contact Democratic Services on 01732 227000 or [democratic.services@sevenoaks.gov.uk](mailto:democratic.services@sevenoaks.gov.uk).

**SEVENOAKS JOINT TRANSPORTATION BOARD**

Minutes of the meeting held on 8 March 2017 commencing at 7.00 pm

Present: Cllr. London (Vice Chairman in the Chair)

County Councillors Parry and Pearman

District Councillors Clack, Edwards-Winsler, Esler, Layland and  
Williamson

Apologies for absence were received from County Councillors Chard,  
Crabtree, Gough, Horwood and District Councillor Barnes

District Cllrs. Dickins and Piper were also present.

31. Minutes

The Chairman advised that there was a typographical error in the minutes published in the agenda. The resolution in Minute 24 should have read “Turners Gardens” rather than Turners Green and had already been corrected in the minutes before him.

Resolved: That the minutes of the meeting held on 6 December 2016, be agreed and signed by the Chairman as a correct record, subject to the following amendments

- a) the insertion of the words “he had been advised by the KCC General Counsel that” before “it was not a prejudicial interest” at Minute 20; and
- b) the correction of a typographical error at Minute 21, where it should have referred to the “Brighton Main Line”.

32. Declarations of interest

No additional declarations of interest were made.

33. Matters Arising/Update (Including Actions from Previous Meetings)

The Sevenoaks District Manager (KCC) updated Members that since the publication of the agenda there had been further email discussions with Brasted Parish Council regarding the various proposals and Officers were awaiting a response.

The completed actions were noted.

34. Informal Consultation - Parking Proposal - Grange Close, Edenbridge

The Parking Engineer presented a report that advised the Board on the results of an informal consultation in respect of parking proposals for Grange Close, Edenbridge. He advised that a petition had been received in early 2016. In November and December 2016 an informal consultation was undertaken with residents that sought their views on proposals aimed at improving the parking situation.

Members' attention was brought to the parking proposals, the informal consultation responses and Officer's comments and recommendations.

Resolved: That

- a) the results of the informal consultation in respect of parking proposals for Grange Close, Edenbridge and Officer's comments and recommendations within the report, be noted; and
- b) Officers be asked to undertake a statutory consultation in respect of making a traffic regulation order to cover the parking proposals for Grange Close, Edenbridge as set out at Appendix 1 to the report.

35. Applications for Disabled Person's (Blue Badge) Parking Bays

The Parking Engineer presented a report that advised the Board on the locations of the latest applications for Disabled Persons' Parking Bays (DPPBs) that had been evaluated by the District Council in accordance with KCC's assessment criteria. The report set out those applications which did not meet the criteria and would proceed no further and the informal consultation responses and Officer comments on those which did pass the assessment criteria. Members noted that no objections were received to the successful applications during the informal consultation.

In response to a question, the Parking Engineer advised that amendments to Traffic Regulation Order were made in batches to achieve cost savings. Interim DPPBs were therefore employed until the TRO could formally be amended.

Resolved: That

- a) it be noted that the application for a parking bay for disabled persons' vehicles in Penenden, New Ash Green did not meet KCC's assessment criteria and would proceed no further; and
- b) Officers proceed with interim bays with a view to undertaking the TRO procedure at a later stage for the following applications for parking bays for disabled persons' vehicles which did meet KCC's assessment criteria
  - i) Greatness Lane, Sevenoaks; and

ii) Meadway, Halstead.

36. Statutory Consultation - Minor On -Street Parking Proposals - TRO 2013 Amendment 21

The Parking Engineer presented a report that explained that a 3-week consultation was undertaken during January 2017 in respect of minor on-street parking proposals in Riverhead, Sevenoaks, Sundridge and Westerham within the KCC (Various Roads in the District of Sevenoaks) (Prohibition and Restriction of Waiting and Loading and Unloading and On-Street Parking Places) (Amendment 21) Order 2017. The report set out the results of that consultation and the Board was asked to consider any objections received and Officer comments and to decide whether the proposals should be proceeded with.

The Parking Engineer updated Members that Westerham Town Council had since withdrawn their objection to the parking proposals for The Grange, Westerham. This had been withdrawn in time, meaning that the Board did not have to consider whether the objection should be set aside.

The local County Councillor urged that the objections to the proposals for Sundridge be set aside, noting that the money was ready to implement the scheme.

Resolved: That

- a) the results of the statutory consultation regarding minor on-street parking proposals within The Kent County Council (Various Roads in the District of Sevenoaks) (Prohibition and Restriction of Waiting and Loading and Unloading and On-Street Parking Places) (Amendment 21) Order 2017 (known as TRO 2013 Amendment 21) be noted;
- b) the relevant objections received to the parking proposals for Sundridge - Main Road (A25) and service road shown in Appendix 3 of the report, be set aside;
- c) TRO Amendment 21 be made and the parking proposals therein set out in Appendices 1 to 5 to the report be implemented as drawn; and
- d) the objectors be notified of the Board's decision.

37. Sevenoaks Highway Works Programme 2016/17

Members' considered a report which gave an update on the identified schemes approved for construction in 2016/17.

## Agenda Item 1

### Sevenoaks Joint Transportation Board - 8 March 2017

County Councillor Parry raised concerns that parking proposals for Hopgarden Lane, Sevenoaks discussed at the meeting of the Board on 6 December 2016 may be unnecessary. He had found that the vehicles displaced by local parking schemes were local traffic rather than commuters.

*Action: That KCC Officers contact County Councillor Crabtree to enquire whether she intended to proceed with funding the parking scheme for Hopgarden Lane, Sevenoaks.*

Resolved: That the report be noted.

#### 38. Sevenoaks Cycling Strategy Working Group

The Chairman of the Sevenoaks Cycling Strategy Working Group introduced the action notes from the meeting of the Working Group held on 20 February 2017 and explained that he felt that progress had been made after a number of years of inactivity. He highlighted that he had been asked to raise the issue of funding and he asked that the Cabinet of the District Council consider contributing some money towards the £15,000 feasibility study for Cycling Strategy Route 1: East/West Cycle Route.

Resolved: That the Sevenoaks District Council Cabinet be requested to consider contributing towards the £15,000 cost of the feasibility study for Cycling Strategy Route 1: East/West Cycle Route.

#### CHAIRMAN'S ANNOUNCEMENTS

The Chairman noted that it would be the last Board meeting for County Councillors Pearman and Parry and thanked them for their hard work and contributions.

THE MEETING WAS CONCLUDED AT 7.30 PM

CHAIRMAN

**ACTIONS FROM THE MEETING HELD ON 8 MARCH 2017 AND UPDATES FROM PREVIOUS MEETINGS**

	<b>Action date</b>	<b>Description</b>	<b>Status and last updated as at 15.5.2017</b>	<b>Contact Officer</b>
1	8.3.2017	<p>Minute 38, Hopgarden Lane, Sevenoaks.</p> <p>That KCC Officers contact County Councillor Crabtree to enquire whether she intended to proceed with funding the parking scheme for Hopgarden Lane, Sevenoaks.</p>	<p>Following discussions with residents and the Member, Margaret Crabtree, the Scheme is currently on hold and is under review, a decision on how the scheme is to be taken forward will be made within 6 to 8 weeks.</p>	<p>Geoffrey Bineham Schemes Project Manager</p> <p>Tel: 03000 418181</p>

This page is intentionally left blank



**Item 4 - Response to Minute 38, 8 March 2017, from Sevenoaks Joint  
Transportation Board**

Further to Minutes 38 of the Sevenoaks Joint Transportation Board meeting held on 8 March 2017 a reference was sent to Cabinet which met on 20 April 2017, relevant minute extract below:

**88. Matters referred from Sevenoaks District Joint Transportation Board and  
Scrutiny Committee**

- a) Members considered the reference form the Sevenoaks District Joint Transportation Board, which asked Cabinet to consider contributing towards the £15,000 cost of the feasibility study for Cycling Strategy Route 1: East/West Cycle Route.

The Chairman exercised his discretion and allowed Mr. Andrew Michaelides, a member of the Sevenoaks Cycling Forum, to address the meeting. He explained that this route was a low cost link between Worships Hill in Riverhead and the Trinity School site which involved enlarging some footpath and improving signage. A desktop review had been carried out but no feasibility or design study carried out. He realised it was a Kent County Council (KCC) responsibility but was requesting a contribution in order to get it started.

The Chairman advised that a decision could not be taken that evening as it was a KCC responsibility and there would need to be some consultation with them.

Resolved: That Officers be requested to consult with KCC and work closely with them to find possible ways to move this forward.

This page is intentionally left blank

## SEVENOAKS RESIDENTS' PARKING REVIEW

Sevenoaks Joint Transportation Board - 14 June 2017

Report of Chief Officer Environmental and Operational Services

Key Decision: No

---

### Executive Summary:

This report provides an update on the further consideration of on-street parking restrictions in Zone A in Sevenoaks and the proposed report on parking provision in the town.

---

Portfolio Holder Councillor Matthew Dickins

Contact Officer(s) John Strachan, Ext. 7310

---

### Recommendation to Sevenoaks Joint Transportation Board:

The report be noted and officers be advised to postpone further consideration of parking provision in Zone A until a holistic review of parking in the town as a whole can be carried out.

---

### Introduction & Background

- 1 Members will recall that at the meeting on 6 December 2016, officers presented a report on parking in Zone A, with particular consideration to Gordon Road and Argyle Road. The report and appendices demonstrated that there was no evidence to support a change to the restrictions in the Zone.
- 2 Some residents of Gordon Road and Argyle Road attended the meeting to speak to the item and submitted a proposal requesting one of three alternative parking arrangements which they felt would better suit their needs.

The Board resolved that:

- a) *“Officers be recommended to begin the process for consulting on further restrictive parking measures in Gordon and Argyle Road, Sevenoaks, as set out in Option A of the petition, except with visitor parking only to be limited to 2 hours; and*
- b) *Officers draft a report to consider parking provision in Sevenoaks town as a whole, in consultation with local Board Members who*

## Agenda Item 6

*express interest, to be presented at the next ordinary meeting of the Board.”*

Option A referred to a proposal that would restrict parking to permit holders only in parts of Gordon and Argyle Roads.

- 3 Since the December meeting, the new Bradbourne multi-storey car park has opened enabling a number of commuters, who parked in pre-approved parts areas on-street, to now park in the Bradbourne car park, which has provided further relief in Zone A.

### **Scope for Reviewing Parking Management**

- 4 Town centre parking is a finite resource and changes to its management should be considered carefully so as not to unfairly disadvantage any particular user such as residents, shoppers, workers, tourists or other visitors. Furthermore, the Council has long taken the view that wherever possible there should be a range of parking in the town centre to support those with different levels of income. In reaching its resolution, Members recognised that any changes to arrangements in Zone A would disadvantage other legitimate users at a time when availability of parking is at a premium, hence ‘resolution b’ was proposed by the then Chairman and duly passed.
- 5 Despite the evidence previously presented to the Board, further consideration of parking on Gordon and Argyle Road is not ruled out. However, to do so in isolation would risk creating the aforementioned problems. Likewise, the need for a review of parking in Sevenoaks town centre is supported but such an exercise must again take a holistic, rather than piecemeal, approach to ensure the needs of the largest possible number of people are met and in the most efficient manner possible, to help support the town. Such a review will be a considerable undertaking, taking many months and involving a wide range of stakeholders. Whilst the parking on Gordon and Argyle Roads is not long-stay (except for permit-holders), Members will be aware of the particular pressures on long-stay spaces within the town. It is therefore considered that such a comprehensive review of parking provision could only take place once the Council has been able to meet the demonstrable need for long-stay spaces by increasing provision at Buckhurst 2.

### **Proposed Action**

- 6 Members are therefore advised to postpone further consideration of parking provision in Zone A until a holistic review of parking in the town as a whole can be carried out.
- 7 Should the Board wish to proceed with the informal consultation originally recommended under resolution ‘a’, it would remain scheduled for the first quarter of 2018.
- 8 Irrespective of the Board’s recommendation, the Council will continue to carry out an enhanced enforcement regime in Zone A, focusing in particular

on Gordon and Argyle Roads, to help ensure the scheme operates efficiently, thereby enhancing the experience of resident permit holders and other legitimate users.

### **Key Implications**

#### Financial, Legal, Risk, Human Rights & Equality Impacts

None.

### **Conclusions**

The Council wishes to ensure the needs of residents are balanced with the needs of others who also need to park in Sevenoaks town centre. Work is planned to increase parking capacity in the town, after which a first principles review of all parking provision is planned. The approach recommended at the December meeting would hinder the Council's aims and the proper management of parking within the town. In the meantime, should there be a material change in the situation officers will bring this to the attention of the Board.

**Appendices**                      None

**Background Papers**    [Sevenoaks Residents' Parking Zone A Report & Appendices, 6 December 2016](#)

[Minutes of the Meeting of Sevenoaks Joint Transportation Board, 6 December 2016](#)

[Petition and Supporting Documents Relating to Parking in Gordon and Argyle Roads, 6 December 2016](#)

**Richard Wilson**  
**Chief Officer Environmental and Operational Services**

This page is intentionally left blank

**STATUTORY CONSULTATION - MINOR ON-STREET PARKING PROPOSALS**

**VARIOUS LOCATIONS - TRO 2013 AMENDMENT 23**

**Sevenoaks Joint Transportation Board - 14 June 2017**

Report of Chief Officer, Environmental and Operational Services

Status: For Decision

Key Decision: No

---

**Executive Summary:** The consideration of the objection to the minor on-street parking proposals within The Kent County Council (Various Roads in the District of Sevenoaks) (Prohibition and Restriction of Waiting and Loading and Unloading and On-Street Parking Places)(Amendment 23) Order 2017 received during the statutory consultation

---

**This report supports the Key Aim of**

- Caring Communities
- Sustainable Economy

**Portfolio Holder** Cllr. M Dickins

**Contact Officer** Jeremy Clark

---

**Recommendation to Sevenoaks Joint Transportation Board:**

It is recommended that:

- (a) the results of the statutory consultation regarding minor on-street parking proposals within The Kent County Council (Various Roads in the District of Sevenoaks) (Prohibition and Restriction of Waiting and Loading and Unloading and On-Street Parking Places)(Amendment 23) Order 2017 (known as “TRO 2013 Amendment 23” be noted;
  - (b) the relevant objection received to the parking proposals for Edenbridge - Grange Close be set aside;
  - (c) TRO 2013 Amendment 23 be made and the parking proposals therein be implemented as drawn; and
  - (d) the objector be notified of the Board’s decision.
-

---

### Reason for recommendation:

The parking proposals are aimed at providing better management of the Public Highway, in line with the Highway Code and current legislation.

---

### Background/Introduction

- 1 A statutory consultation was undertaken over a 3-week period from 13 April 2017 in respect of minor on-street parking proposals contained in a draft traffic regulation order entitled The Kent County Council (Various Roads in the District of Sevenoaks) (Prohibition and Restriction of Waiting and Loading and Unloading and On-Street Parking Places) (Amendment 23) Order 2017, hereafter known as “TRO 2013 Amendment 23”.
- 2 The parking proposals include changes to existing and/or new waiting restrictions in the following roads, which are shown on the plans and are described in Appendices 1 to 4:
  - Edenbridge - Grange Close (see Appendix 1)
  - Sevenoaks - St Botolphs Road (see Appendix 2)
  - Swanley - Bevan Place (see Appendix 3)
  - Swanley - Station Road (see Appendix 4)
- 3 For the statutory consultation, public notices describing the on-street parking proposals and inviting representations were published in the local press and were erected in each of the locations concerned.
- 4 In the interests of added publicity, information on the proposals for Edenbridge - Grange Close was also sent to local addresses
- 5 During the 3-week statutory consultation period, which ended on 5 May 2017, an objection was received in respect the parking proposals for Edenbridge - Grange Close.
- 6 The purpose of this report is therefore for the Sevenoaks Joint Transportation Board to consider the relevant objection, together with Officers’ comments and recommendations given in Appendix 1, and to decide whether, before TRO 2013 Amendment 23 is made, to:
  - set aside the objection and implement all of the proposals as drawn; or
  - uphold the objection and modify (by reduction) or abandon the parking proposals for Edenbridge - Grange Close.

(It should be noted that it is only possible to amend proposals by reduction. Any extension to the proposed restrictions or change of type of restriction would form a new proposal and require re-advertisement)



- 7 No objections were received in respect of the parking proposals in Appendices 2 - 4, and hence these can be implemented without the need for a decision from the Board. These locations have been included for information.

### **Other Options Considered and/or Rejected**

- 8 Officers have considered the feasibility and desirability of reducing the extent of or abandoning the proposal to which the objection was received, but considered this to be inappropriate.

### **Key Implications**

#### Financial

The costs incurred in implementing the proposals will vary depending on the Board's decision, but if all the proposals in TRO 2013 Amendment 23 are taken forward, the estimated total cost would be in the region of £3,000.

A local resident has agreed to meet the cost of the parking proposal in Sevenoaks - St Botolphs Road, which is required due to the relocation of the resident's driveway, the cost of which is estimated at £350.

The District Council can meet the cost of the other proposals, estimated at £2,650, from its parking account.

#### Legal Implications

A traffic regulation order (TRO) must be made under the Road Traffic Regulation Act 1984 (RTRA 1984) to cover the proposed on- and off-street parking changes.

Section 1 of the RTRA 1984 states that a TRO may only be made for the following purposes:

- avoiding danger to persons or traffic (including for anti-terrorist purposes);
- preventing damage to the road or to buildings nearby (including for anti-terrorist purposes);
- facilitating the passage of traffic;
- preventing use by unsuitable traffic;
- preserving the character of a road especially suitable for walking or horse riding;
- preserving or improving amenities of the area through which the road runs; and
- for any of the purposes specified in paragraphs (a) to (c) of the Environment Act 1995 (air quality).

## Agenda Item 8

To meet one or more of the above, a TRO may prohibit, restrict or regulate the use of a road or any part of the width of a road by vehicular traffic of any class. It may have effect at all times or at specified periods or times. Specific classes of traffic may be excepted.

Before making a TRO, a formal (statutory) consultation procedure must be followed in accordance with The Local Authorities' Traffic Orders (Procedure) (England and Wales) Regulations 1996.

Any objections made to the TRO received during this statutory consultation (other than frivolous or irrelevant ones) that are not withdrawn would be reported to the Sevenoaks Joint Transportation Board for a decision to be made on whether to make the TRO as proposed, to vary it (by reduction) or to abandon it.

### Equality

The decisions recommended in this report have a remote or low relevance to the substance of the Equalities Act. There is no perceived impact on end users.

### **Risk Assessment Statement**

There are no additional risks identified that are outside those already covered within the standard Risk Assessment for carrying out parking enforcement on the Public Highway.

### **Appendices:**

Appendix 1 - Edenbridge - Grange Close -  
Description and plan of parking proposals, details  
of objection and Officers' comments  
For decision

Appendix 2 - Sevenoaks - St Botolphs Road -  
Description and plan of parking proposal  
For information

Appendix 3 - Swanley - Bevan Place -  
Description and plan of parking proposals  
For information

Appendix 4 - Swanley - Station Road -  
Description and plan of parking proposals  
For information

### **Background Papers**

The Traffic Signs Regulations and General  
Directions 2016  
<http://www.legislation.gov.uk/uksi/2016/362>

The Road Traffic Regulation Act 1984, as  
amended.  
[www.legislation.gov.uk/ukpga/1984/27](http://www.legislation.gov.uk/ukpga/1984/27)

The Local Authorities' Traffic Orders (Procedure)  
(England and Wales) Regulations 1996.  
[www.legislation.gov.uk/cy/uksi/1996/2489/made](http://www.legislation.gov.uk/cy/uksi/1996/2489/made)

The Highway Code.  
[www.gov.uk/browse/driving/highway-code](http://www.gov.uk/browse/driving/highway-code)

**Richard Wilson**  
Chief Officer, Environmental and Operational Services

This page is intentionally left blank

APPENDIX 1

EDENBRIDGE - GRANGE CLOSE - PARKING PROPOSALS - FOR DECISION

Description and plan of parking proposals, details of objection and Officers' comments/recommendation

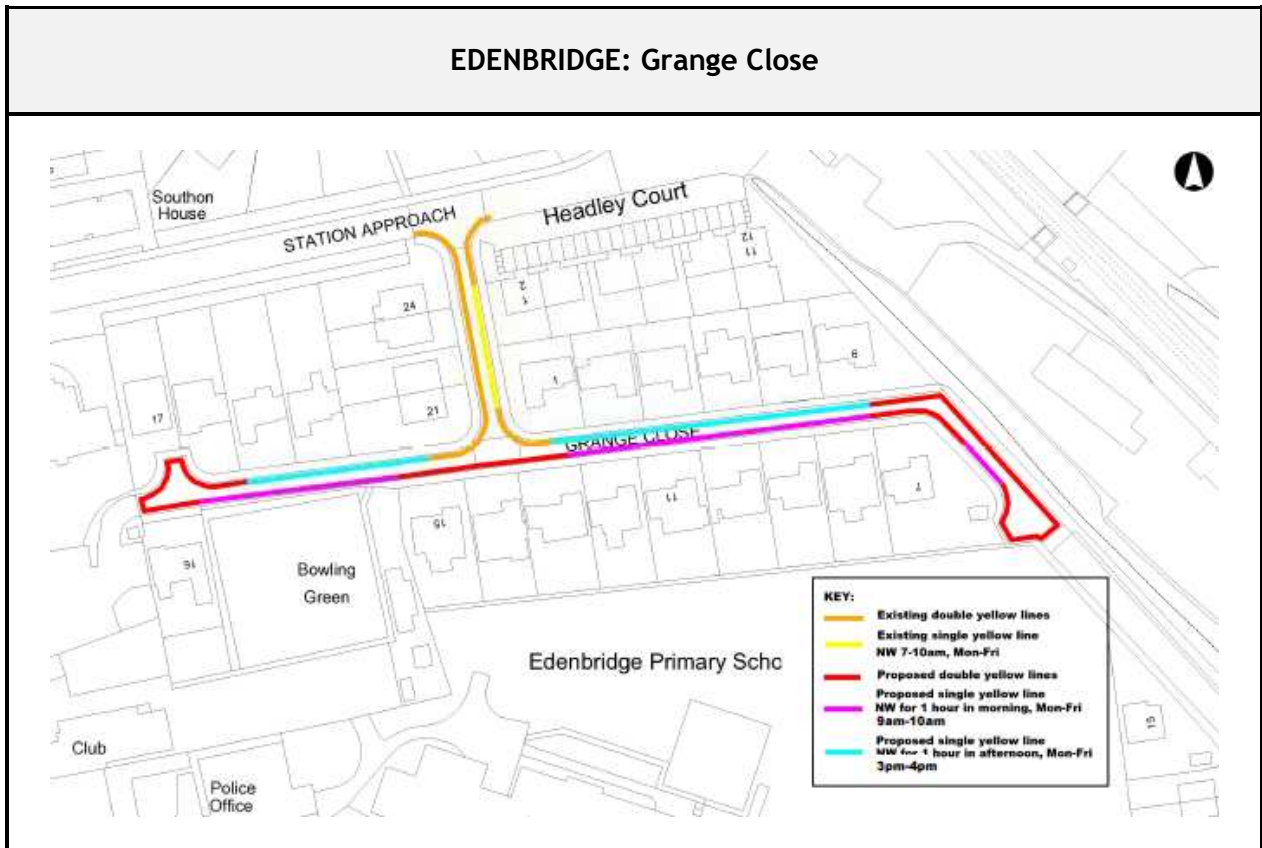

Description	Proposed Changes
North side, from a point 1.5m east of a point in line with the common boundary of 18 & 19 Grange Close, westwards to a point in line with the western boundary of no. 17 Grange Close	New double yellow line restrictions (no waiting at any time)
South side, from a point in line with the western boundary of no. 16 Grange Close, eastwards following the kerb line to a point 0.5m east of a point in line with the eastern boundary of no. 16 Grange Close	
South side, from a point in line with the western boundary of no. 15 Grange Close eastwards to a point 1.5m west of a point in line with the common boundary of nos. 12 & 13 Grange Close	
South and southwest sides, from a point 0.5m west of a point in line with the common boundary of nos. 7 & 8 Grange Close, eastwards then south eastwards following the kerb line for 19.5m	
Southwest side, from a point 35.5m east then south east of a point in line with the common boundary of nos. 7 & 8 Grange Close, south eastwards following the kerb	

## Agenda Item 8

### APPENDIX 1

#### EDENBRIDGE - GRANGE CLOSE - PARKING PROPOSALS - FOR DECISION

Description and plan of parking proposals, details of objection and Officers' comments/recommendation

line to a point in line with the southern boundary of no. 7 Grange Close	
Southeast, northeast and north sides, from a point in line with the southern boundary of no. 7 Grange Close, north eastwards then north westwards, then westwards, following the kerb line, to a point 12m east of a point in line with the common boundary of nos. 5 & 6 Grange Close	
North side, from a point 1.5m east of a point in line with the common boundary of 18 & 19 Grange Close, westwards to a point in line with the western boundary of no. 17 Grange Close	
North side, from a point 62m south then west of the southern kerb line of Station Approach westwards to a point 1.5m east of a point in line with the common boundary of nos. 18 & 19 Grange Close	New single yellow line restrictions (no waiting between 3pm and 4pm, Monday to Friday)
North side, from a point 12m east of a point in line with the common boundary of nos. 5 & 6 Grange Close, to a point 62m south then east of the southern kerb line of Station Approach	
South side, from a point 0.5m east of a point in line with the eastern boundary of no. 16 Grange Close, eastwards to a point in line with the western boundary of no. 15 Grange Close	New single yellow line restrictions (no waiting between 9am and 10am, Monday to Friday)
South side, from a point 1.5m west of a point in line with the common boundary of nos. 12 & 13 Grange Close, eastwards to a point 0.5m west of a point in line with the common boundary of nos. 7 & 8 Grange Close	New single yellow line restrictions (no waiting between 9am and 10am, Monday to Friday)
Southwest side, from a point 19m east then south east of a point in line with the common boundary of nos. 7 & 8 Grange Close, south eastwards for 16.5m	New single yellow line restrictions (no waiting between 9am and 10am, Monday to Friday)

APPENDIX 1

EDENBRIDGE - GRANGE CLOSE - PARKING PROPOSALS - FOR DECISION

Description and plan of parking proposals, details of objection  
and Officers' comments/recommendation

DETAILS OF OBJECTION	
1	I agree with the proposed single yellow lines in blue, but I do not want double yellow line between 17 & 18 Grange Close. Often our gardeners need to park in this area, and double yellow line are not required here.

OFFICERS' COMMENTS/RECOMMENDATION	
<p><b>COMMENTS:</b> The proposed double yellow line restrictions outside and opposite 17 &amp; 18 Grange Close are required to protect the vehicle turning head in this cul-de-sac from obstruction by parked vehicles. Within the regulations controlling the proposed restrictions, there are certain exemptions, one of which is the ability for vehicles to stop briefly whilst dropping off or picking up goods or passengers. This exemption will allow the objector's gardeners to load/unload their equipment, garden refuse etc., and allow operatives to board/alight from their vehicle outside these addresses, after which, the vehicle can be moved to a suitable parking place.</p> <p><b>RECOMMENDATION:</b> It is recommended that the objections be set aside, and the proposal be implemented, as drawn.</p>	

This page is intentionally left blank



**APPENDIX 2**  
**SEVENOAKS - ST BOTOLPHS ROAD - PARKING PROPOSALS - FOR INFORMATION**  
 Description and plan of parking proposals

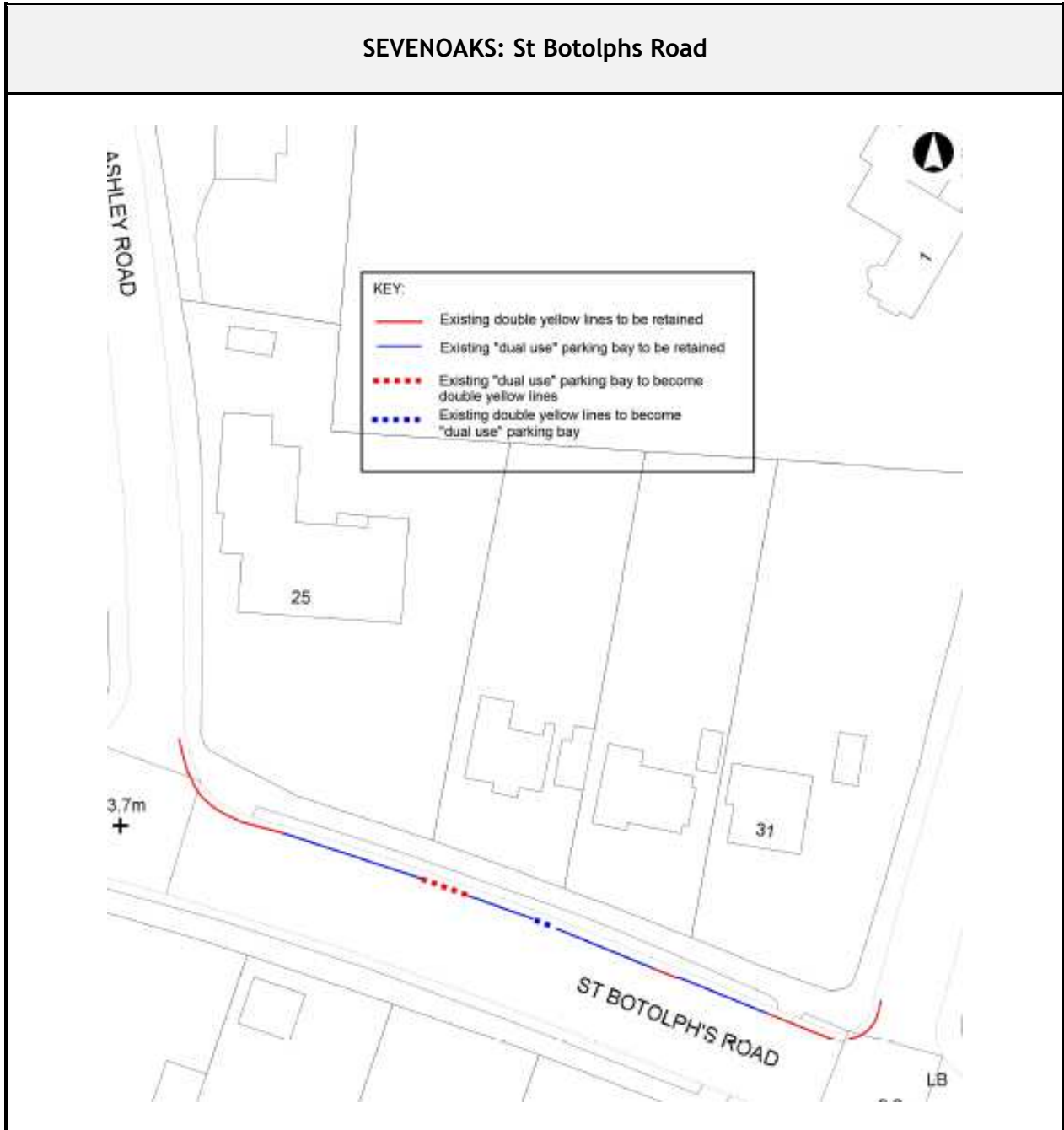

Description	Proposed Changes
North side, between Ashley Road and Vine Avenue	Adjustments to existing double yellow line restrictions (no waiting at any time) and “dual use” (resident permit/pay-and-display) parking bays.  Note: the proposed changes are required in connection with the closure of an existing vehicle access and the creation of a new vehicle access at no. 27, and to ensure that the signed/marked restrictions are correctly described in the Consolidation Order.

This page is intentionally left blank

**APPENDIX 3**  
**SWANLEY - BEVAN PLACE - PARKING PROPOSALS - FOR INFORMATION**  
 Description and plan of parking proposals

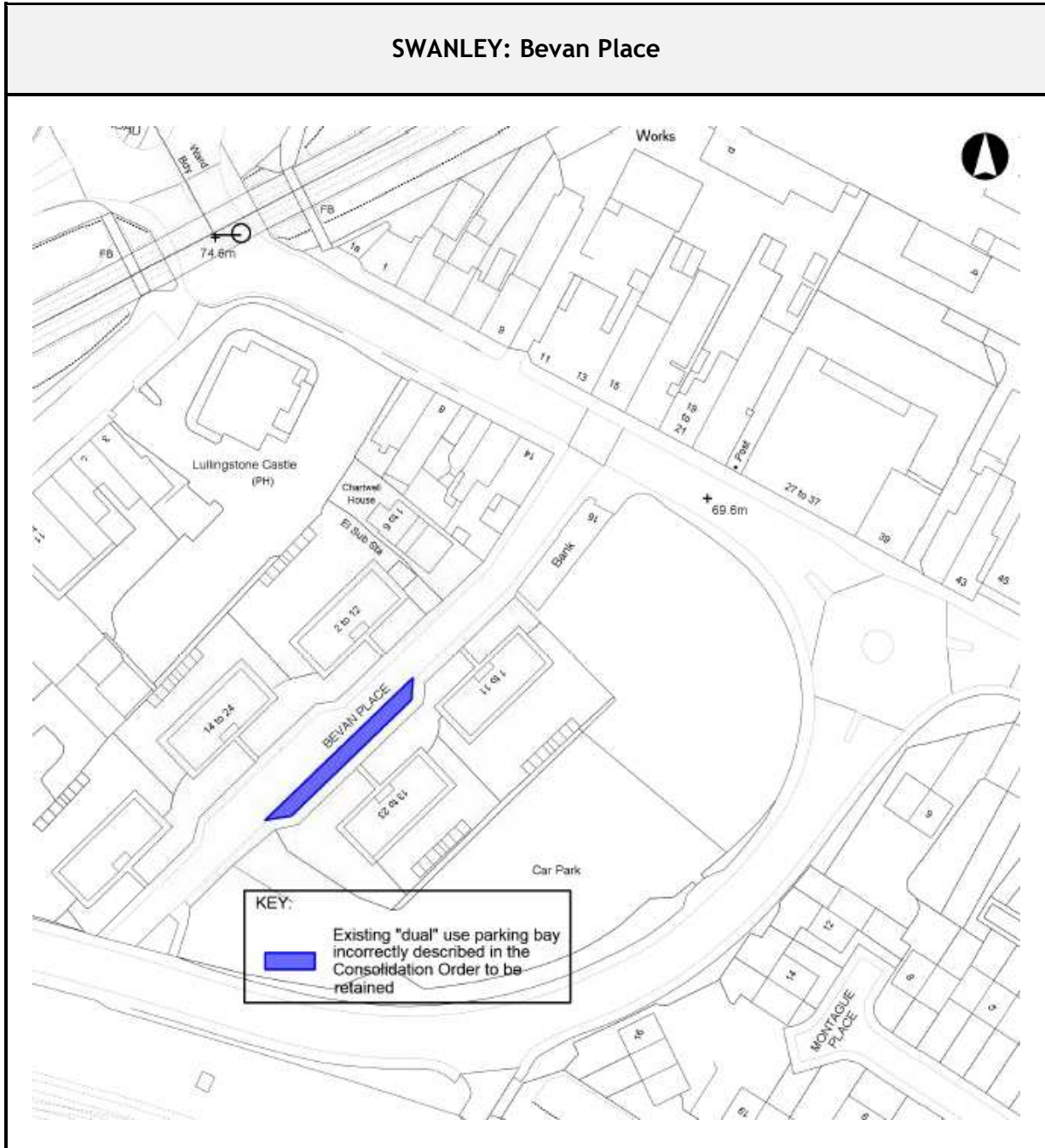

Description	Proposed Changes
Southeast side, from a point 55m south west of its junction with High Street, south westwards for 39m	New “dual use” parking bay (resident permit SW2/limited wait (no waiting for longer than 2 hours (no return within 1 hour) between 8.30am and 6.30pm, Monday to Saturday, excl. Bank Holidays) Note: There will be no material change to the existing “dual use” parking bay as signed/ marked in Bevan Place. This is a housekeeping exercise to ensure that the restriction is correctly described in the Consolidation Order.

This page is intentionally left blank

**APPENDIX 4**  
**SWANLEY -STATION ROAD - PARKING PROPOSAL - FOR INFORMATION**  
 Description and plan of parking proposals

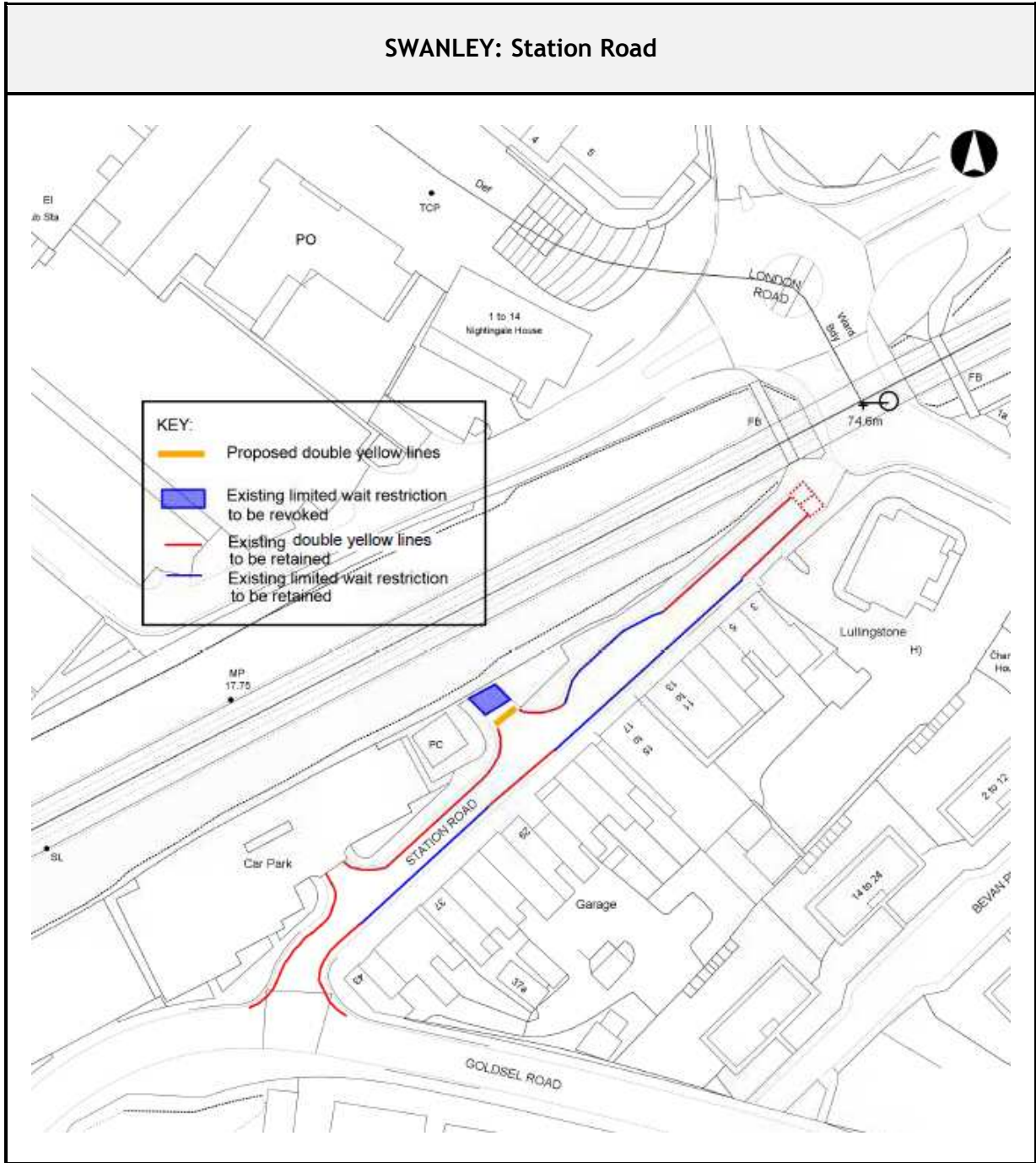

Description	Proposed Changes
Northwest side, in turning head adjacent to former public conveniences	New double yellow line restrictions (no waiting at any time) to replace existing limited wait restriction (no waiting for longer than 30 minutes (no return within 30 minutes) between 8.30am and 6.30pm, Monday to Saturday).

This page is intentionally left blank

## APPLICATIONS FOR DISABLED PERSONS' (BLUE BADGE) PARKING BAYS

Sevenoaks Joint Transportation Board - 14 June 2017

**Report of** Chief Officer, Environmental and Operational Services

**Status:** For Decision

**Key Decision:** No

---

**Executive Summary:** Information report on the applications received for disabled persons' (blue badge) parking bays at locations within the District.

---

This report supports the Key Aim of

- Caring Communities (by providing parking facilities for disabled people)
- Sustainable Economy (by improving travel arrangements and reducing congestion)

**Portfolio Holder** Cllr. Dickins

**Contact Officer(s)** Jeremy Clark Ext. 7323

---

### **Recommendation to Sevenoaks Joint Transportation Board:**

That the Board notes the report on the applications for disabled persons' (blue badge) parking bays to be provided within the District.

---

### **Reason for recommendation:**

The recommendations are aimed at providing better management of the public highway, in line with current legislation and the Highway Code

---

### **Introduction and Background**

- 1 Kent County Council (KCC) has the power to provide on-street parking places on roads within its area for which it is the traffic authority for the purpose of relieving or preventing congestion on the public highway.
- 2 This power is frequently exercised to establish disabled persons' (blue badge) parking bays (DPPBs) close to the homes of disabled persons who would otherwise have difficulty parking near to their homes.
- 3 An application process exists, through which a person can request that a DPPB is established close to their home.

## Agenda Item 9

- 4 The District Council administers local requests for DPPBs on behalf of KCC, and manages and funds their provision.
- 5 KCC has produced an application form and guidance notes for requests for DPPBs, which is available for applicants to download from the District Council's website.
- 6 KCC has also produced assessment criteria for the District Council to use when considering applications, the details of which were reported to the meeting of the Sevenoaks Joint Transportation Board on 3<sup>rd</sup> September 2015.
- 7 The purpose of this report is to advise the Board on the locations of the latest batch of applications for DPPBs received from individuals that have been evaluated in accordance with KCC's assessment criteria. These are summarised in Appendix 1 of this report.
- 8 Since none of this batch of applications met KCC's assessment criteria, and will therefore proceed no further, this report is for information only.

### Key Implications

#### Financial

There are no financial implications to this report.

#### Legal Implications and Risk Assessment Statement

There are no legal implications.

#### Equality Assessment

The recommendation of this report has a remote or low relevance to the substance of the Equality Act. There is no perceived impact on end users.

#### Safeguarding Children and Vulnerable Adults

The report deals with the assessment of applications for disabled persons' (blue badge) parking bays, in line with KCC's policy and assessment criteria.

#### **Appendices:**

Appendix 1 - For Information - Applications for disabled persons' (blue badge) parking bays which did not meet KCC's assessment criteria

#### **Background Papers:**

The Equality Act 2010

<http://www.legislation.gov.uk/ukpga/2010/15>

The Traffic Signs Regulations and General Directions 2016

<http://www.legislation.gov.uk/uksi/2016/362>

The Highways Act 1980, as amended.



<http://www.legislation.gov.uk/ukpga/1980/66>

The Road Traffic Act 1988, as amended.

<http://www.legislation.gov.uk/ukpga/1988/52>

The Road Traffic Regulation Act 1984, as amended.

<http://www.legislation.gov.uk/ukpga/1984/27>

The Traffic Management Act 2004, as amended.

<http://www.legislation.gov.uk/ukpga/2004/18>

The Highway Code.

<https://www.gov.uk/browse/driving/highway-code>

**Richard Wilson**

**Chief Officer, Environmental and Operational Services**

This page is intentionally left blank

**APPENDIX 1 - FOR INFORMATION**

**Applications for disabled persons' (blue badge) parking bays  
which did not meet Kent County Council's assessment criteria**

Requested Location for Disabled Persons' (Blue Badge) Parking Bay	Reason Declined
---	-----------------

<b>HARTLEY</b>	
Brambledown	KCC's assessment criterion relating to receipt of appropriate benefits (e.g. higher rate of Disability Living Allowance, higher rate of Attendance Allowance or enhanced mobility component of Personal Independence Payment) not met by the applicant

<b>HORTON KIRBY</b>	
The Street	KCC's assessment criterion relating to receipt of appropriate benefits (e.g. higher rate of Disability Living Allowance, higher rate of Attendance Allowance or enhanced mobility component of Personal Independence Payment) not met by the applicant

<b>NEW ASH GREEN</b>	
Ayelands	KCC's assessment criterion relating to receipt of appropriate benefits (e.g. higher rate of Disability Living Allowance, higher rate of Attendance Allowance or enhanced mobility component of Personal Independence Payment) not met by the applicant

This page is intentionally left blank

**To:** Sevenoaks Joint Transportation Board  
**By:** KCC Highways and Transportation  
**Date:** 14<sup>th</sup> June 2017  
**Subject:** Highway Works Programme 2017/8  
**Classification:** Information Only

---

Summary: This report updates Members on the identified schemes approved for construction in 2017/18

---

## 1. Introduction

1(1) This report provides an update and summarises schemes that have been programmed for delivery in 2017/18

2. **Footway and Carriageway Improvement Schemes** – see Appendix A

3. **Drainage Repairs & Improvements** – see Appendix B

4. **Street Lighting** – see Appendix C

5. **Transportation and Safety Schemes** – see Appendix D

- **Casualty Reduction Measures** – see Appendix D1
- **Integrated Transport Schemes** – see Appendix D2

6. **Developer Funded Works** – see Appendix E

7. **Bridge Works** – see Appendix F

8. **Traffic Systems** – see Appendix G

9. **Combined Member Fund** – see Appendix H

## 10. Conclusion

10(1) This report is for Members information.

---

**Contacts: Carol Valentine / Julian Cook 03000 418181**

### Contact Officers:

The following contact officers can be contacted on **03000 418181**

Carol Valentine	Highway Manager (West)
Julian Cook	Sevenoaks District Manager
Sue Kinsella	Street Lighting Manager
Kevin Gore	Drainage Manager / Structures Manager
Alan Casson	Resurfacing Manager
Toby Butler	Traffic Systems
Emma Green	Transportation and Safety Schemes / Combined Member Fund
Jamie Hare	Developer Funded Work

## Agenda Item 10

**The delivery of these schemes is weather dependent; should it prove not possible to carry out these works on the planned dates, new dates will be arranged and the residents will be informed by a letter drop to their homes.**

<b>Machine Resurfacing – Contact Officer Mr Byron Lovell</b>			
<b>Road Name</b>	<b>Parish</b>	<b>Extent of Works</b>	<b>Current Status</b>
B2028 Hartfield Road, Edenbridge	Edenbridge	Junction with Roman Road and before Broadfields	Programmed 18 <sup>th</sup> April
A25 High Street, Seal	Seal	Between Keepers Cottage and School Lane	Programmed 20 <sup>th</sup> April
Morley's Roundabout	Sevenoaks Weald	Circulatory of roundabout	To be programmed
A225 High Street & A224 London Road, Sevenoaks	Sevenoaks	Oak Lane to A224 London Road	Programmed 31 <sup>st</sup> May
Worships Hill	Riverhead	Between Cold Arbor Road and Cranmer Road	To be programmed
<b>Footway Improvement - Contact Officer Mr Neil Tree</b>			
<b>Road Name</b>	<b>Parish</b>	<b>Extent and Description of Works</b>	<b>Current Status</b>
Brattle Wood	Sevenoaks	From its junction with Garth Road to its junction with Beechmont Road. (Footway reconstruction)	Works Substantially Complete. Currently liaising with legal and local resident in regard to allergy issues for completion of last remaining section.
London Road	Sevenoaks	From O/S No.1 Station Parade, London Road to O/S No.11 St Botolph's Road (Footway Protection)	In Design To be programmed
Mill Hill	Edenbridge	(south side) High Street to Mead Road (North side) O/S No.122 to High Street. (Footway Reconstruction)	In Design To be programmed

<b>Surface Treatments – Contact Officer Mr Clive Lambourne</b>			
<b>Road Name</b>	<b>Parish</b>	<b>Extent and Description of Works</b>	<b>Current Status</b>
Spout Lane	Crockham Hill	B2026 to Dennettsland Road Surface Dressing	To be programmed. Planned for June 2017
A25 Westerham Road	Brasted	Beggars Lane to Brasted Sand Pits Micro Surfacing	To be programmed. Planned for Spring/Summer 2017
Star Hill Road	Chevening	Morants Court Road to Old London Road Micro Surfacing	To be programmed. Planned for Spring/Summer 2017
Swan Lane	Edenbridge	B2027 to B2026 Micro Surfacing	To be programmed. Planned for Spring/Summer 2017
Spring Hill / Fordcombe Road	Penshurst	Colliersland Bridge to Mitre Farm Micro Surfacing	To be programmed. Planned for Spring/Summer 2017
Hartley Bottom Road	Hartley	Hartley Hill to Manor Road Surface Dressing	To be programmed. Planned for June 2017
London Road	Westerham	Pilgrims Way to Beggars Lane Micro Surfacing	To be programmed. Planned for Spring/Summer 2017
Hartley Bottom Road	Hartley	Hartley Hill to Redhill Road Micro Surfacing	To be programmed. Planned for Spring/Summer 2017
Broad Lane	Penshurst	Full Length Surface Dressing	To be programmed. Planned for June 2017
Four Elms Road	Edenbridge	B2026 to Wayside Drive Micro Surfacing	To be programmed. Planned for Spring/Summer 2017
Malthouse Road	Ash-Cum-Ridley	Pease Hill to Plaxdale Green Rd Micro Surfacing	To be programmed. Planned for Spring/Summer 2017
Green Lane	Hever	"Chittenden" bends to Scallops Micro Surfacing	To be programmed. Planned for Spring/Summer 2017
Ide Hill Road	Sundridge	Church Road to Emmetts Lane Micro Surfacing	To be programmed. Planned for Spring/Summer 2017
Truggers Lane	Chiddingstone	Hoath Corner to Walnut Tree Cross Farm Micro Surfacing	To be programmed. Planned for Spring/Summer 2017
Highlands Hill	Swanley	Beechenlea Rd to west of School Lane Micro Surfacing	To be programmed. Planned for Spring/Summer 2017

## Agenda Item 10

Pilgrims Way	Brasted	Hogtrough Hill to Brasted Hill Micro Surfacing	To be programmed. Planned for Spring/Summer 2017
Penn Lane	Sundridge	Church Road to Little Norman Street Micro Surfacing	To be programmed. Planned for Spring/Summer 2017
Fawkham Road	West Kingsdown	30 mph/de-restriction to Westfield Cotts Micro Surfacing	To be programmed. Planned for Spring/Summer 2017
Back Lane	Chevening	Cold Arbor Rd to B2042 Surface Dressing	To be programmed. Planned for June 2017
Button Street	Swanley	Wood Street to M25 Bridge Micro Surfacing	To be programmed. Planned for Spring/Summer 2017
French Street	Westerham	Hosey Common Road to end Surface Dressing	To be programmed. Planned for June 2017
Canada Farm Road / Scudders Hill	H Kirby / Fawkham	Rabbits Road to Valley Road Surface Dressing	To be programmed. Planned for June 2017
Brasted Lane	Knockholt	Stoneings Lane to Main Road Surface Dressing	To be programmed. Planned for June 2017
Three Gates Road	Fawkham	Canada Farm Road to Speedgate Hill Surface Dressing	To be programmed. Planned for June 2017
Hogtrough Hill	Brasted	Pilgrims Way to The Nower Surface Dressing	To be programmed. Planned for June 2017
Magpie Bottom	Shoreham	Row Dow La to Birchin Cross Road Surface Dressing	To be programmed. Planned for June 2017
School Lane	Horton Kirby	Three Gates Rd to 30 mph signs at H Kirby village Surface Dressing	To be programmed. Planned for June 2017

### Appendix B – Drainage

<b>Drainage Works – Contact Officer Kevin Gore</b>			
<b>Road Name</b>	<b>Parish</b>	<b>Description of Works</b>	<b>Current Status</b>
No Drainage works planned over £5000			



**Appendix C – Street Lighting**

Structural testing of KCC owned street lights has identified the following as requiring replacement this financial year. A status of complete identifies that the column replacement has been carried out. Programme dates are identified for those still requiring replacement.

<b>Street Lighting Column Replacement – Contact Officer Sue Kinsella</b>			
<b>Road Name</b>	<b>Parish</b>	<b>Description of Works</b>	<b>Status</b>
Garrolds Close	Swanley	Replacement of 2 columns	1 complete, 1 transfer of service remaining
High Street	Sevenoaks	Replacement of 2 columns	Columns installed and working, embellishment kits and painting required to finish
Station Road	Swanley	Replacement of 1 column	Installed and working requires painting
Braeside Avenue	Sevenoaks	Replacement of 1 column	Planned for May 2017
Beechmont Road	Sevenoaks	Replacement of 1 column	Planned for May 2017
Coopers Close	South Darent	Replacement of 2 columns	Planned for May 2017
Oak Lane	Sevenoaks	Replacement of 2 columns	1 complete, 1 remaining
Oakleigh Close	Swanley	Replacement of 1 column	Planned for May 2017
Sea Hollow Road	Sevenoaks	Replacement of 1 column	Planned for May 2017
Shrubbery Road	South Darent	Replacement of 4 columns	Planned for May 2017
The Grange	South Darent	Replacement of 2 columns	Planned for May 2017
Turners Gardens	Sevenoaks	Replacement of 1 column	Planned for May 2017
Stangrove Road	Edenbridge	Replacement of 1 column	Planned June 2017
Wellingtonia Way	Edenbridge	Replacement of 1 column	Planned June 2017
London Road	Swanley	Replacement of 1 column	Planned July/Aug 2017
Tonbridge Road	Sevenoaks/A21	Replacement of 1 column	Planned May/June 2017
Tonbridge Road	Sevenoaks	Replacement of 1 sign	Planned May 2017
Goldsel Road	Crockenhill	Replacement of 2 signs	Planned May 2017
Tonbridge Road	Sevenoaks	Replacement of 1 column	Complete

## Agenda Item 10

Location	Parish/Ward	Description of Works	Lead officer	Current Status
Offord Road	Sevenoaks	Replacement of 1 column		Complete
Bradbourne Vale Road	Sevenoaks	Replacement of 1 column		Planned May 2017

### **Appendix D – Transportation and Safety Schemes**

#### **Appendix D1 - Casualty Reduction Measures**

Identified to address a known history of personal injury crashes

Location	Parish	Description of Works	Lead officer	Current Status
A25 Westerham Road junction with A21 slip roads and Homedean Road,	Chevening	Development of potential Crash Remedial Scheme.  Our consultants, Amey PLC have completed an options report.  Preferred option is to change the current junction layout to a roundabout.	Geoffrey Bineham	Preliminary design has been completed by our consultants.  Detailed design will be carried out in 2017/18.  The scheme will be put forward for funding for construction in 2018/19
A225 junction with Franks Lane, Horton Kirby	Horton Kirby	Development of potential Crash Remedial Scheme.  The scheme is to enhance the advance warning signage on the junction approaches.	Geoffrey Bineham	Scheme is currently undergoing design, with a view to construct during summer/Autumn 2017
A20 junction with Button Street, Farningham	Farningham	Development of potential Crash Remedial Scheme.  The scheme is to temporarily close the central reservation crossover gap following several serious crashes. The crashes involved vehicles turning right out of Button Street using the crossover and colliding with motorcyclists.  The scheme will be undertaken using an experimental TRO.	Geoffrey Bineham	Scheme is currently undergoing design, with a view to construct during summer/Autumn 2017

#### **Appendix D2 - Integrated Transport Schemes**

All other LTP funded non-casualty reduction schemes

## Agenda Item 10

White Oak Estate, Swanley	Swanley	Kent 20mph Public Health Scheme.  20mph speed limit on residential roads to the north of London Road to encourage walking and cycling.	Annette Fletcher	Design work is being progressed by our consultants Amey, with a view to construct during the summer/autumn 2017
White Oak Estate, Swanley	Swanley	Provision of DDA dropped kerbs throughout the estate to rectify discontinuation of vulnerable user routes	Geoffrey Bineham	Scheme is currently undergoing design, with a view to construct during summer/Autumn 2017
A224 Orpington Bypass and Old London Road, Badgers Mount	Badgers Mount	Provision of speed limit roundel road markings to enhance the current speed limits in the residential area of Badgers Mount.	Geoffrey Bineham	Scheme is currently undergoing design, with a view to construct during summer/Autumn 2017

### Local Growth Funded Schemes

Location	Parish/Ward	Description of Works	Lead officer	Current Status
A224 Polhill (Morrants Court roundabout)	Chevening and Dunton Green	Consultants are being commissioned to undertake a feasibility study to improve the roundabout for cyclists.	Katie Cullen	The consultants Amey have completed the report on alternative safety improvements with costings.  The scheme has been added to all current major funding bids for Highway improvements and awaits a decision on whether the scheme will receive funding for construction in 2017/18

**Appendix E – Developer Funded Works**

Developer Funded Highway Works (Section 278 Works)				
File Ref.	Road Name	Parish	Description of Works	Current Status
SE 2083	Crowhurst Lane	West Kingsdown	Provision of traffic calming measures in Crowhurst Lane together with signing and bollards to enable pedestrian access to new development. Also resurfacing part of Crowhurst Lane in vicinity of new development	Problems with S.38 element of agreement. Waiting for Housing Association to change unbound material on driveways. First Certificate not yet issued. A meeting was held in December with a contractor on behalf of the Housing Association who are currently assessing the costs involved before works can be carried out.
SE 2086	Four Elms Road / Station Road.	Edenbridge	Pedestrian improvement works comprising new footway on Four Elms Road including dropped crossing with tactiles either side and other minor alterations. A new zebra crossing on Station road. (the new zebra crossing in Station Road was installed by KCC using S.106 contribution money)	Works now adopted
SE 003020	Old Sevenoaks Police Station, Morewood Close	Sevenoaks	Minor works to existing highway including new	Works now adopted.

## Agenda Item 10

			bellmouth into private development, footway works and tactile paving at junction with London Road includes secondary means of access for emergency services	
SE 003025	M&S Store, London Road and Pembroke Road	Sevenoaks	Various new entrances including vehicle crossings and a new bellmouth together with various Variable Message Signs in town centre locations	Works now adopted
SE 003026	Junction of Powder Mills Lane and Hollow Trees Drive	Leigh	Alterations to bellmouth access to private street leading to new development including footway alterations in Powder Mills Lane	Waiting for remedial works to be completed. First Certificate not yet issued. Developer has conducted a CCTV survey and now needs to complete remedial works and add tactile paving before scheme can be placed on a reduced 3 month maintenance period.
SE 003029	Old Ambulance Station, Moor Road	Otford	New Bellmouth and associated footway works	First Certificate issued. Works currently serving maintenance period. Pre adoption inspection to be held in May 2017.
SE 003035	Eglantine Lane	Horton Kirby	New access bellmouth and accommodation works to existing highway	Works have been completed but waiting for developer to produce as built

## Agenda Item 10

				drawings before 12 month's maintenance period can commence.
SE 003036	Mill House, Mill Lane, Bat and Ball	Sevenoaks	New Footway and minor improvements to existing road	Works have started and are due to be completed in near future. The works will serve a year's maintenance period before adoption in 2018.
SE 003040	London Road and Ruxton Close	Swanley	New bellmouth entrance to rear of development off Ruxton Close and accommodation works including ramped access in grassed verge off London Road	Highway works have now been completed. A final inspection meeting will take place in due course and the works will then need to serve a year's maintenance period before adoption.
SE 003048	Grange Close	Edenbridge	New Vehicle Crossovers and associated footway works	Works have now started and are expected to be concluded later in 2017. The works will serve a year's maintenance period before adoption in 2018.
SE003049	Morewood Close	Sevenoaks	SDC Temporary Car Park. Includes pedestrian crossings, tactile paving and vehicle crossing. Footway to be reinstated and vehicle crossing removed when car park is no longer required.	Technical Approval has not been granted. Not heard back from SDC although works have been completed?

## Agenda Item 10

SE003050	Rowhill Road	Hextable	New bellmouth entrance for private car park to allow for school parking. Includes new pedestrian crossings with tactile paving and keep clear parking restrictions. Additional minor footway improvements	Works have now started and are expected to be concluded before Schools reopen after Easter 2017. Some issues over moving telegraph pole with UKPN. The works will serve a year's maintenance period before adoption in 2018
SE003051	Old Fox's Garage Site A224 Orpington By-pass and Old London Road, Badgers Mount	Shoreham	Minor highway improvements including kerb realignment and footway works in connection with conversion of old garage to care home. Also includes road surfacing in front of existing bus shelter in old London Road. Improvements to PROW funded by S.106 agreement.	Submission received. Technical Assessment under way.
SE 003052	Bradbourne Vale Road	Sevenoaks	New bellmouth entrance for private car parking area for new residential development. Includes minor improvements to pedestrian footway and relocation of Bus Stop markings and flag	Submission received. Technical Assessment under way.
SE 003054	Croft Road	Westerham	New bellmouth entrance for private car parking area for new residential development.	Submission received. Technical Assessment under way.

## Agenda Item 10

			Includes minor improvements to pedestrian footway	
TO 003075	Powder Mills Lane and Leigh Road	Leigh	Redevelopment of old Pharmaceutical Works - minor modification to existing carriageway and footway including new bus stop facility in Powder Mills Lane.	Works have been completed and are currently serving a year's maintenance period. The works will be adopted in early part of 2018

### Appendix F – Bridge Works

<b>Bridge Works – Contact Officer Kevin Gore</b>			
<b>Road Name</b>	<b>Parish</b>	<b>Description of Works</b>	<b>Current Status</b>
No works planned			

### Appendix G – Traffic Systems

There is a programme of scheduled maintenance to refurbish life expired traffic signal equipment across the county based upon age and fault history. The delivery of these schemes is dependent upon school terms and holiday periods; local residents, businesses and schools will be informed verbally and by a letter drop of the exact dates when known.

<b>Traffic Systems - Contact Officer: Toby Butler</b>		
<b>Location</b>	<b>Description of Works</b>	<b>Current Status</b>
No traffic signal refurbishment work being carried out this year		



**Appendix H – Combined Member Grant programme**

The following list of schemes includes those which have been approved for funding by both the relevant Member and by Roger Wilkin, Director of Highways and is up to date as of 4<sup>th</sup> May 2017.

The details below are for Highway Schemes **only** and **does not** detail contributions Members have made to other groups such as Parish and District Councils or list traffic speed surveys.

More detail on Combined Member Grant schemes can be accessed by each Member via the online database or by contacting their Combined Member Grant Engineer.

**Roger Gough – Darent Valley**

<b>Scheme</b>	<b>Status</b>
Horton Kirby – HGV signing	Scheme complete
High Street, Eynsford – Proposed parking restrictions	Scheme complete
Green Court Road, Crockenhill – Proposed parking restrictions on eastern side of road	Scheme complete
Crockenhill Gateways – proposed gateway features at entrance to village	Scheme on hold – To be reviewed after May elections

**Nick Chard – Sevenoaks East**

<b>Scheme</b>	<b>Status</b>
Seal village – Proposed 20mph speed limit and right turn prohibition	Scheme complete – Some remedial works required
Pilgrims Way East, Otford - Proposed safety scheme to enhance pedestrian warning signs and speed limit signage	Scheme complete – Some remedial works required

**Clive Pearman – Sevenoaks South**

<b>Scheme</b>	<b>Status</b>
No schemes outstanding	N/A

**Richard Parry – Sevenoaks West**

<b>Scheme</b>	<b>Status</b>
Hosey Hill, Westerham - Proposed safety scheme to extend parking restrictions	Scheme complete
Hopgarden Lane, Sevenoaks – Parking restrictions (Shared with Margaret Crabtree)	Scheme on hold – To be reviewed after May elections

**Margaret Crabtree – Sevenoaks Central**

<b>Scheme</b>	<b>Status</b>
Kippington Area, Sevenoaks - Parking restrictions	Scheme complete
Hopgarden Lane, Sevenoaks – Parking restrictions (Shared with Richard Parry)	Scheme on hold – To be reviewed after May elections

**Michael Horwood - Swanley**

<b>Scheme</b>	<b>Status</b>
St Marys Road, Swanley – 20mph speed limit signage enhancements	Scheme complete
Pedestrian Safety Improvements – Series of bollards to segregate pedestrian vehicular movements adjacent to shops.	Works completed

## Agenda Item 10

### David Brazier – Sevenoaks North East

Scheme	Status
No schemes outstanding	N/A





	<p>Feasibility work will be completed towards the end of May. The engineers will look at giving two prices for the work (a) Otford to Bat &amp; Ball junction and (b) Bat &amp; Ball junction to the Vine Cricket Ground. KC suggested a special meeting to discuss the plans. It was agreed that the meeting should take place during the day. Initial suggestions for a meeting include the end of June/beginning of July.</p> <p>There are some sections with cycle routes on both sides of the road. The design of cycle route over the motorway bridge is on one side. The design can be discussed in detail at the special meeting with the engineer.</p> <p>KC raised a number of Issues including the bridge over the M26 - Highways England bridge and the parapets are too low for a cycle route. The standard railing can be replaced. KC to work with OPC once the Group has met with the engineers.</p>	
57.	<p><b>Sevenoaks District Cycling Strategy Review 2017</b></p> <p>SDC has spoken with KCC on how this can be moved forward.</p>	
58.	<p><b>Local Plan Update</b></p> <p>ST gave an update on the Local Plan and explained the process. The Planning Policy team is producing an “Issues and Options” document which will look at a number of issues facing the District. Topics will include housing, employment, infrastructure, transport etc. The document will be discussed at the Planning Advisory Committee (22 June) and Cabinet (13 July) before going out to public consultation.</p> <p>Potential to update the Transport Strategy and the Cycling Strategy at the same time. ST will be discussing this with KCC in the near future.</p> <p>The Department for Transport has recently released a number of documents and strategies around walking and cycling (<a href="https://www.gov.uk/government/collections/cycling">https://www.gov.uk/government/collections/cycling</a>). Guidance has also been released for Local Authorities on Local Cycling and Walking Infrastructure Plans.</p>	<p>ST to inform the Group when the Issue &amp; Options document is available and circulate the link to the Planning Advisory Committee papers (once available).</p>
59.	<p><b>AOB</b></p> <p>Bikeability training - Cllr Eyre has contacted the SDC Parking Manager to discuss options for suitable car parks to use. ST to provide KC with KC details. The sessions will likely take place on a Sunday. KCC to confirm.</p>	<p>ST to pass contact details to KC</p>
60.	<p><b>Date of next meeting</b></p> <ul style="list-style-type: none"> <li>End of June/July - special engineers meeting will be arranged to discuss Route 6.</li> </ul>	<p>ST to circulate and arrange</p>

## Agenda Item 11

	<ul style="list-style-type: none"><li>• The next JTB meeting is scheduled for <b>12<sup>th</sup> September</b>. Therefore it is proposed the next Working Group will take place <b>week commencing 31<sup>st</sup> July or week commencing 7<sup>th</sup> August</b>. The Group stated they preferred a day meeting with no preference to either morning or afternoon timings. DE asked if conference call facilities could be provided for those members of the Group that might not be able to attend.</li></ul>	<p>dates for both meetings with KC.</p> <p>ST to arrange next meeting. ST to check whether conference calling is available for those members who may not be able to attend a day meeting.</p>
--	--	---